

TOPOGRAPHIC SURVEY
for
STEVE EAST

A PORTION OF THE N.W. 1/4 OF THE S.E. 1/4 OF SECTION 34, T.24N., R.4E., W.M. KING COUNTY, WASHINGTON

LEGAL DESCRIPTION:
LOT 6, BLOCK 5, SECOND ADDITION TO SUMMIT PLACE ACCORDING TO THE PLAT THEREOF RECORDED IN VOLUME 16 OF PLATS, PAGE 21, IN KING COUNTY, WASHINGTON;
EXCEPT THE SOUTH 70 FEET THEREOF.

BENCH - DATUM (NAVD 88)
BRASS CAP LOCATED 0.5 FEET SOUTH AND 0.5 FEET EAST OF THE INTERSECTION OF BACK OF CONCRETE SIDEWALK IN THE NORTHEAST CORNER OF THE INTERSECTION OF S. HENDERSON ST. AND 48TH AVE. S.
ELEV. = 91.98

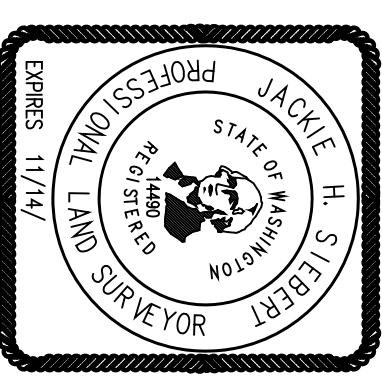

<p>Tri-County Land Surveying Company 4610 200th St. S.W. Suite A Lynnwood, Wa. 98036 (425)776-2926 Fax: 776-2860</p>	
DRAWN BY B.H.	DATE JULY, 2007
CHECKED BY R.S.	SCALE 1" = 20'
JOB NO. 07-089	SHEET 1 OF 1